

20000±150mm

With IC Chip DS16EV5110A

High Speed HDMI™ Cable with Ethernet E358026 AWM STYLE 20276 80°C 30V VW-1

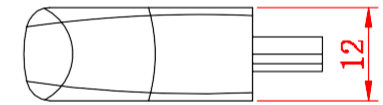
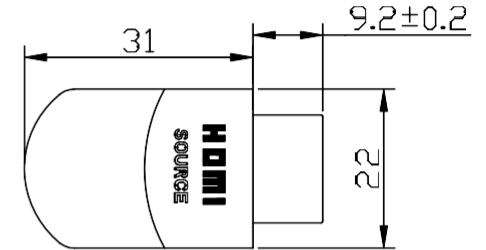
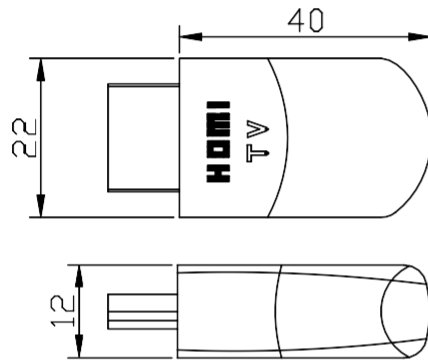
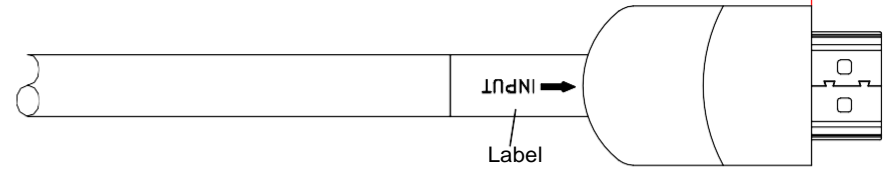
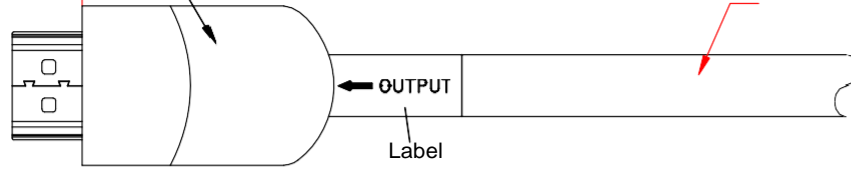
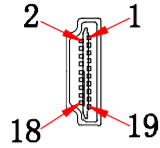

PIN Assignment

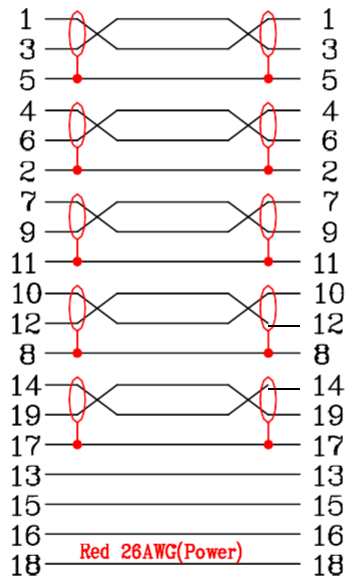

SHELL _____ SHELL

注意:HDMI线有一根26AWG(7C/0.16TC)红色粗线为5V的HDMI供电线,必须焊接在HDMI端子的18PIN

26AWG HDMI Cable

[(7C/0.16TC+FPE OD:1.25mm)*1P+7C/0.12TC+HDPE OD:0.7mm +AL]*5P+(7C/0.12TC+HDPE OD:0.7mm)*3C+(7C/0.16TC+HDPE OD:0.8mm)*1C+AL+1C/0.32BC+ 128#/0.12AL+ PVC OD:8.5mm

ELECTRICAL TEST:

1. 100% OPEN SHORT MIS WIRE TEST
2. CONTACT RESISTANCE:10OHM MAX
3. INSULATION RESISTANCE:5M OHM MIN
4. HI-POT TEST:DC 300V/10ms

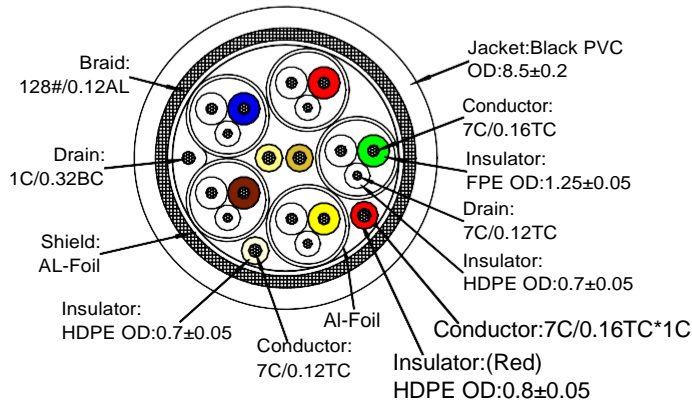

| 4 | Cable:26AWG/Black/ø8.5 | 1 | PCS |
|-----|------------------------|-------|------|
| 3 | 45P Black PVC | 14 | g |
| 2 | LDPE | 10 | g |
| 1 | HDMI A Male | 2 | PCS |
| NO. | Description | Q' TY | Unit |

| | | | | | | | | | |
|--------------|---------|---------|----------|-------------|---------------------------|-------|------------|-----------|-----------|
| CABLEMASTER™ | | | | DESCRIPTION | FINISHED PRODUCT'S FIGURE | SCALE | 1/1 | UNITS: MM | 3RD ANGLE |
| | | | | MODEL NO. | HDMIV2-20M | △ | | | |
| APPROVED | CHECKED | DRAWING | DESIGNED | DRAWING NO. | | △ | | | |
| | | | ELLA | FINISHING | | △ | 2017/06/26 | | AC |
| | | | | MATERIAL | | SYM | DATE | | REVISION |